

PAINT-MARKING TORQUE WRENCH

TO CHANGE PAINT CARTRIDGE:

1. UNSCREW CARTRIDGE COVER.
2. UNSCREW OLD PAINT CARTRIDGE.
3. SCREW IN NEW PAINT CARTRIDGE.
4. SCREW IN CARTRIDGE COVER.

NOTE: PAINT CARTRIDGE IS NOT PRESSURIZED.

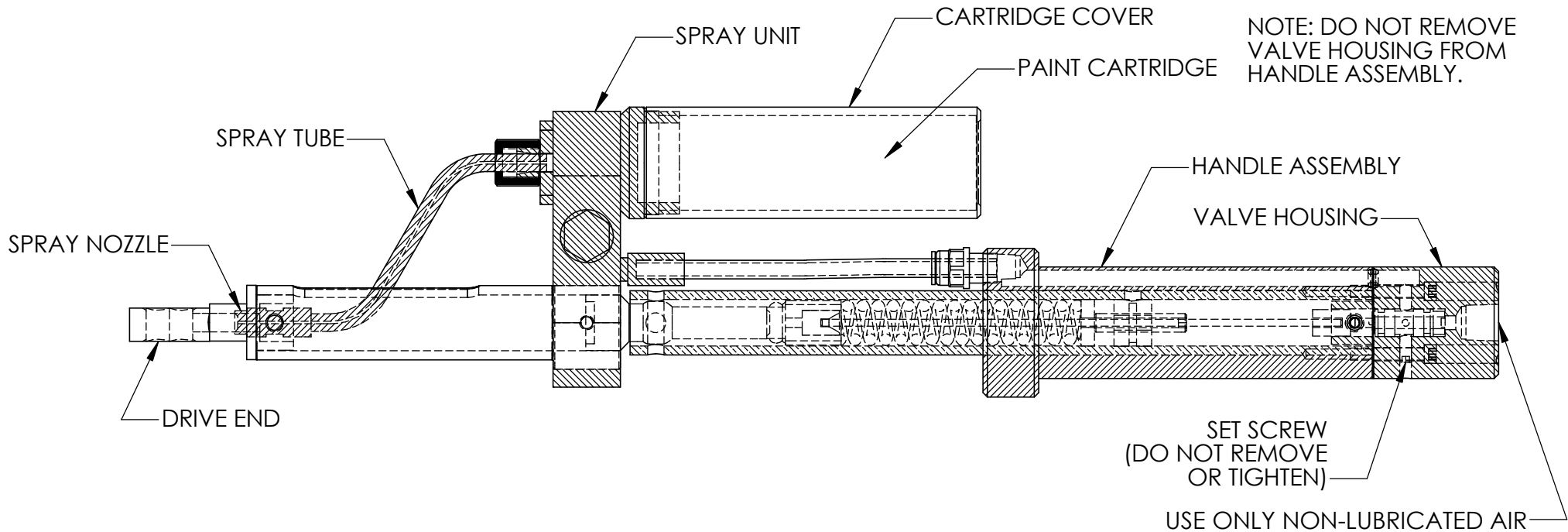

NOTE: IF WRENCH IS NOT TO BE USED FOR MORE THAN EIGHT HOURS, REMOVE DRIVE END AND PLACE PLASTIC CAP ON SPRAY NOZZLE.

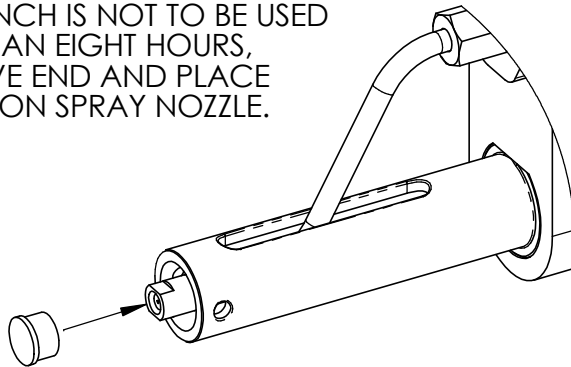

VAN F. **BELKNAP** COMPANY, INC.
A Division of Hank Thorn Company, Inc.

Phone: 248-348-7800 Fax: 248-348-9821
www.belknaptools.com

INSTRUCTIONS FOR ADJUSTING TORQUE:

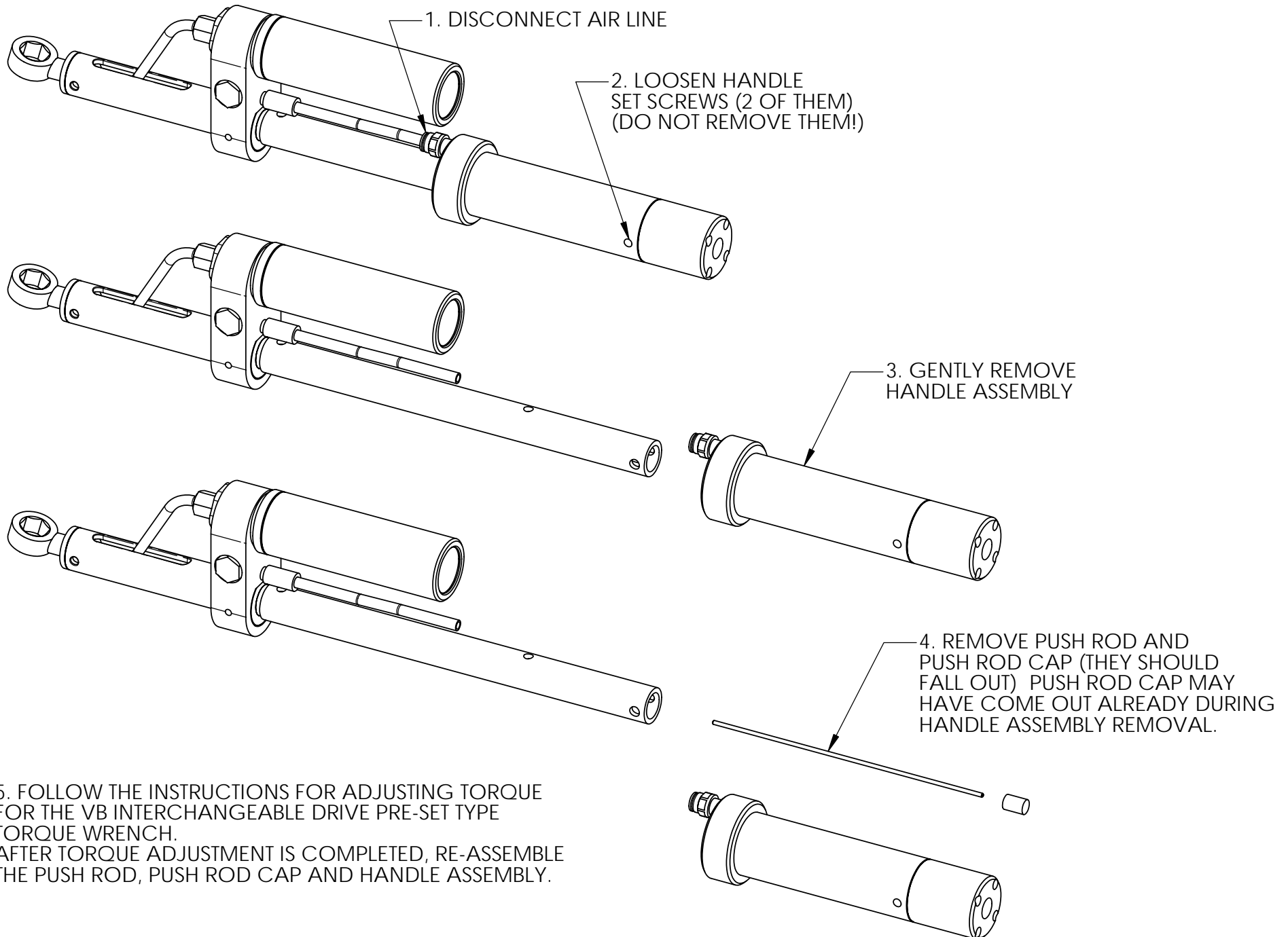



OPERATION GUIDE

INTERCHANGEABLE DRIVE PRE-SET TORQUE WRENCH

SAFETY PRECAUTIONS

- Always wear safety goggles, both user and bystanders.
- An out of calibration torque wrench can cause part or tool breakage.
- Periodic re-calibration is necessary to maintain accuracy.
- Do not exceed rated torque as over-torquing can cause wrench or part failure.
- Do not use torque instrument to break fasteners loose.
- Do not use cheater extension on the handle to apply torque.
- Broken or slipping tools can cause injury.
- Ratchet mechanism may slip or break if dirty, mismatched or worn parts are used, or direction lever is not fully engaged. Ratchets that slip or break can cause injury.

MAINTENANCE / SERVICE

1. The torque wrench's internal mechanism is permanently lubricated during assembly. **Do not attempt to lubricate the internal mechanism.**
2. Clean torque wrench by wiping. **Do not immerse.**



INSTRUCTIONS FOR ADJUSTING TORQUE

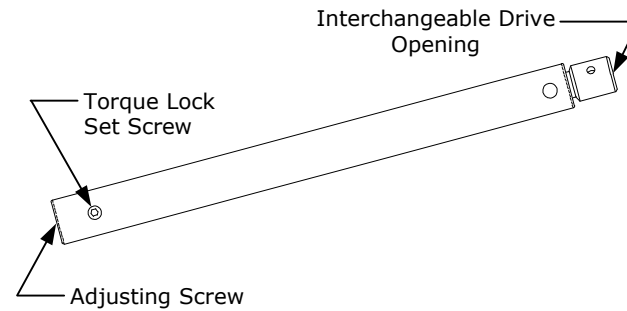

1. When adjusting torque on the VB Interchangeable Drive Pre-set Type Torque Wrench, be sure to insert the desired drive end into the handle, making sure the adapter end is engaged in the pin retainer hole of the torque wrench click arm.
2. Loosen the torque locking set-screw.
3. Mount the torque wrench with the drive end on a torque tester and click the torque wrench to determine the torque output. (See our catalog for our complete line of torque testers at www.belknaptools.com)
4. If adjustment is required: turn adjusting screw clockwise to increase torque output (counter-clockwise to decrease torque.)
CAUTION: When increasing torque, be sure not to exceed the maximum torque of the torque wrench, torque tester, or drive end.
5. Tighten torque locking set-screw after desired torque is reached. Click wrench again to confirm desired torque setting.
6. Identify torque wrench with new torque value and seal adjustment opening.

INSTRUCTIONS FOR USE

1. Always apply force on the torque handle at the center of the hand grip.
2. The torque handle will click and move several degrees in a free arch when torque value has been reached. Do not continue to apply force after the click.
3. Relax pulling effort and the torque handle will automatically reset itself for the next torque cycle.

TORQUE ADJUSTING TOOLS

Adjusting Tool Part Number:	Use on Belknap Torque Wrench(es):
AT-0	VB-5T-I
AT-1	VB-10T-I, VB-10ST-I, VB-10AT-I
AT-2	VB-50T-I, VB-50ST-I
AT-3	VB-100T, VB-200T
AT-4	VB-300T
AT-5	VB-600T
AT-6	VB-1000T

NOTE: Do not apply more torque than is noted on the torque handle. Also, some smaller interchangeable adapter sizes will not take the amount of torque that is noted on the torque handle. Use care in selecting the proper drive end. Do not over torque.

Please return damaged or abused tools to Belknap for inspection. Do not use them.

In addition to periodic torque checks, manufacturer recommends disassembly of this tool for visual inspection of internal parts. Excess wear, chipped or broken parts should be replaced before reassembly, recalibration and return to service.

www.belknaptools.com